

# Fixed Coaxial Attenuator

# WA51

DC – 8.5 GHz

500 WATTS

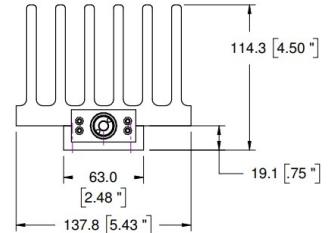
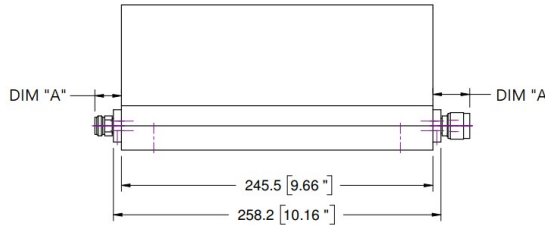

## Features

Type N or DIN 7/16 stainless steel M/F connectors per MIL-STD-348A, interface dimensions mate nondestructively with MIL-PRF-39012. Designed to meet MIL-DTL-3933 environmental specification.

## Specifications

**Nominal Impedance:** 50 ohms.

**Frequency Range:** DC to 8.5 GHz

**Nominal dB Values:** 10 – 40 dB

**Power Coefficient:** < 0.0001 dB/dB/W;  
Unidirectional in power.

**Power Rating:** 500 W maximum average rated power to 25°C ambient temperature, derated linearly to 25 W at 125°C. 5 kW peak power (5 µsec pulse width, 5% duty cycle).

**Temperature Range:** -55°C to +125°C.

**Temperature Coefficient:** <0.0004 dB/dB/°C.

**Construction:** Black aluminum alloy body with passivated stainless steel connectors. Gold plated beryllium copper contacts. RoHS Compliant.

**Calibration:** Insertion Loss and VSWR performed across frequency range. Calibration test data available at additional cost.

## Standard Nominal Values and Deviations:

Attenuation (dB)	Accuracy ± dB
	WA51
10, 20, 30, 40	2.0

## Maximum VSWR:

Frequency (GHz)	VSWR
	WA51
DC - 4	1.25
4 - 8.5	1.45

## Dimensions:

Connector Type (- code)	Length
	Dimension 'A'
N-Type F -03	14.9 (.57)
N-Type M -04	22.7 (.89)
DIN 7/16 F -07	30.5 (1.2)
DIN 7/16 M -08	31.8 (1.25)

**Weight:** 4.1 (144.6)  
**Height:** 114.3 (4.5)  
**Width:** 137.8 (5.43)

*Note: Dimensions are given in mm (in), or kg (oz). Weight figure is nominal, with our standard connector configuration. Additional connector options may be available.*

**Low Intermodulation Option:** Add -LIM after connector option to specify low intermodulation.