

Fixed Coaxial Attenuator

WA50

WA50: DC – 3.0 GHz

2.0 WATTS

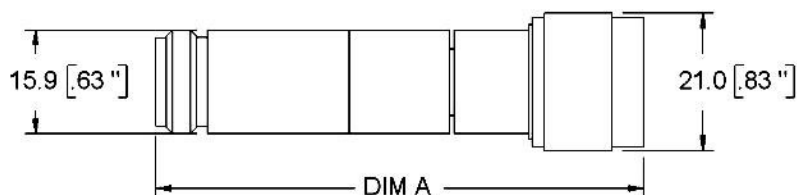

Features

Type N-type stainless steel M/F connectors per MIL-STD-348A, interface dimensions mate non-destructively with MIL-PRF-39012. Designed to meet MIL-DTL-3933 environmental specification.

Specifications

Nominal Impedance: 50 ohms.

Frequency Range: DC - 3 GHz.

Nominal dB Values: 1 - 50 dB

Bidirectional in power.

Power Rating: 2 W average to 25°C ambient temperature, derated linearly to 0 W at 125°C. 1 kW peak (5 µsec pulse width, 0.1% duty cycle).

Temperature Range: -30°C to 70°C

Construction: Stainless steel barrel with passivated stainless steel connectors. Gold plated beryllium copper or stainless steel contacts.

Calibration: Insertion Loss and VSWR performed across frequency range. Calibration test data available at additional cost.

Model WA50 is also available in a calibrated attenuator set WAS1 (3, 6, 10 and 20dB) with certificate of calibration.

Standard Nominal Values and Deviations:

Attenuation (dB)	Accuracy ± dB
	WA50
0 - 12	0.5
13 - 20	0.7
21 - 40	1.0
41 - 60	1.5

Maximum VSWR:

Frequency (GHz)	VSWR
	WA50
DC - 1.0	1.15
1.0 - 3.0	1.2

Dimensions and Weight:

Attenuation (dB)	WA50		
	Length (Dim "A")	Diameter	Weight
1 - 30	74.4 (2.93)	16.0 (.63)	.10 (3.5)
31 - 60	84.6 (3.33)	16.0 (.63)	.13 (4.5)

Note: Dimensions are given in mm (in), or kg (oz). Weight figure is nominal, with our standard connector configuration. Additional connector options may be available.