

Fixed Coaxial Attenuator Low-Profile Mountable

MODEL WA59

DC – 2.5 GHz

100 WATT

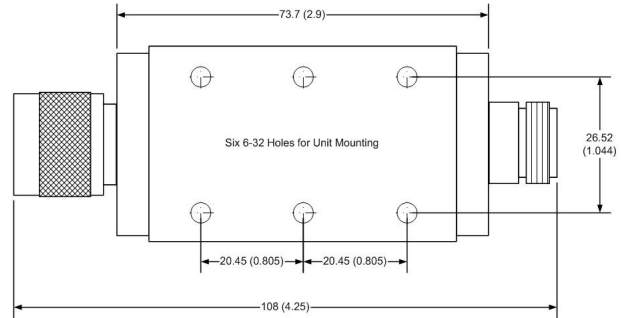
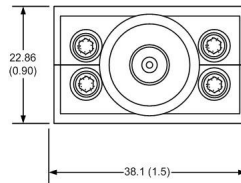

Features

Designed to comply with MIL-DTL-3933.

Conductive Cooling

Flat base with mounting holes

Specifications

Nominal Impedance: 50 ohms.

Frequency Range: DC – 2.5 GHz.

Nominal dB Value: 3 – 40 dB.

Connectors: Type N or SMA stainless steel M/F connectors per MIL-STD-3448A, interface dimensions mate nondestructively with MIL-PRF-39012.

Standard Nominal Values and Deviations:

Attenuation (dB)	Accuracy ± dB
	DC - 2.5 GHz
3 - 40	0.70

Maximum VSWR:

Frequency (GHz)	VSWR
DC - 2.5	1.20

Power: 100W average unidirectional, peak power of 10KW (5 µsec pulse width; 0.5% duty cycle) with case temperature held to +100°C maximum using conductive heat sink.

Construction: Black Aluminum alloy body with passivated stainless steel connectors. Gold plated beryllium copper male/female contacts.

Power Sensitivity: < 0.0005 dB/dB/W.

Temperature Range: -55°C to 125°C.

Temperature Coefficient: < 0.0004 dB/dB/°C.

Calibration: Insertion Loss and VSWR performed across frequency range. Calibration test data available at additional cost.

Weight: .14 kg / 5 oz.

Length:

Connector Type	Length
Type N	108.5 (4.25)
SMA	120.65 (4.75)

Note: Dimensions are given in mm (inches) and are maximum, unless otherwise specified.



WEINSCHEL ASSOCIATES

TEL: 877.948.8342 / 301.963.4630 ♦ Fax: 301.963.8640

WEB: <http://www.WeinschelAssociates.com>

EMAIL: sales@WeinschelAssociates.com

53

Specification
Subject to change
without notice