

Fixed Coaxial Attenuator Low-Profile Mountable

Model WA42

DC – 2.5 GHz

150 Watts

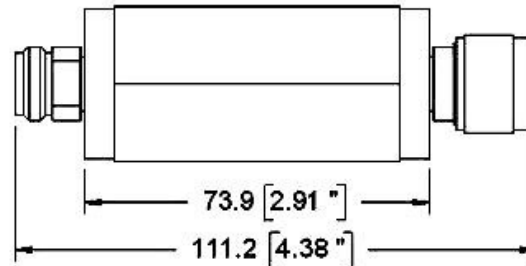
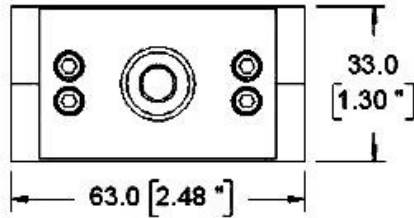

Features

Type N, SMA, or DIN 7/16 stainless steel M/F connectors per MIL-STD-348A, interface dimensions mate nondestructively with MIL-PRF-39012. Designed to meet MIL-DTL-3933 environmental specification. Unit may be mounted in any position.

Specifications

Nominal Impedance: 50 ohms.

Frequency Range: DC - 2.5 GHz.

Nominal dB Values: 3 - 40 dB.

Power Sensitivity: < 0.0001 dB/dB/W.

Power Rating: 150W CW / 10 KW peak; Unidirectional. Peak power of 5Kw; 5 µsec pulse width; 0.5% duty cycle, with case temperature held to +100°C maximum using conductive heat sink.

Temperature Range: -55°C to +100°C.

Temperature Coefficient: < 0.0004 dB/dB/°C.

Standard Nominal Values and Deviations:

Attenuation (dB)	Accuracy ± dB
3 – 40	0.5

Maximum VSWR:

Frequency (GHz)	VSWR
DC - 2.5	1.10

Construction: Aluminum alloy body with passivated stainless steel connectors.

Calibration: Insertion Loss and VSWR performed across frequency range. Calibration test data available at additional cost.

Physical Dimensions:

Connector Type	Length	Weight kg/oz
N Type	174.24 (8.86)	.85/30
SMA	189.89 (7.47)	.79/28
DIN 7/16	265.68 (10.46)	1.02/36

Note: Dimensions are given in mm (inches) and are maximum, unless otherwise specified

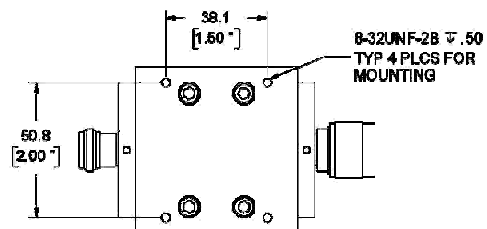

WEINSCHEL ASSOCIATES

TEL: 877.948.8342 / 301.963.4630 ♦ Fax: 301.963.8640

WEB: <http://www.WeinschelAssociates.com>

EMAIL: sales@WeinschelAssociates.com