

TERMINATION

MODEL WA1445

DC – 2.5 GHz

250 WATTS

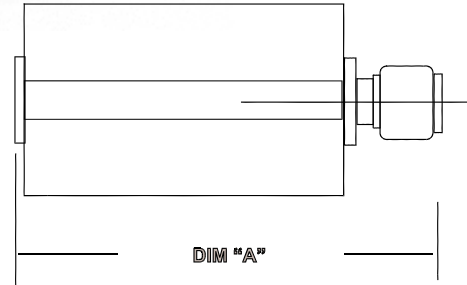
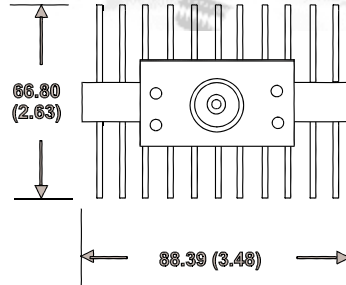

Features

Type N, 4.1 stainless steel M/F, or DIN 7/16 DIN connectors per MIL-STD-348A, interface dimensions mate nondestructively with MIL-PRF-39012. Designed to meet MIL-A-3933 environmental specification.

Maximum VSWR:

Frequency (GHz)	VSWR
DC – 2.5	1.10

Specifications

Nominal Impedance: 50 ohms

Frequency Range: DC – 2.5 GHz

Power Rating: 250 watt CW/ 10KW peak. Maximum rated average power to 25°C ambient temperature, de-rated linearly to 15 watts at 125°C. 10 kilowatt peak (5 µsec pulse width; 1.5% duty cycle).

Temperature Range: -55°C to +125°C

Construction: Black finned aluminum alloy body with passivated stainless steel connector. Gold plated beryllium copper female contact.

Calibration: VSWR performed across frequency range. Calibration test data available at additional cost.

Weight: 1.5 kg/ 3.5 lbs.

Connectors: Type N; stainless steel connectors per MIL-STD-348 Interface dimension mate nondestructively with MIL-PRF-39012 connectors.

Dimension "A": 212.09 (8.350)

Height: 66.80 (2.63)

Width: 88.39 (3.48)

Note: Dimensions are given in mm (inched). Dimensions are maximum unless otherwise specified.



WEINSCHEL ASSOCIATES

TEL: 877.948.8342 / 301.963.4630 ♦ Fax: 301.963.8640

WEB: <http://www.WeinschelAssociates.com>

EMAIL: sales@WeinschelAssociates.com